



COJINETES REDONDOS PARA HACER ROSCAS CON TORNILLO DE REGISTRO

MM	ACERO AL CARBONO				ACERO RÁPIDO			
	Ø 1"	Ø 1 1/2"	Ø 2"	Ø 2 1/2"	Ø 1"	Ø 1 1/2"	Ø 2"	Ø 2 1/2"
2x0,25	5.853				10.830			
M2x0,40	5.853				10.830			
2,3x0,25	5.853				10.830			
M2,3x0,40	5.853				10.830			
M2,5x0,45	5.853				10.830			
2,6x0,35	5.853				10.830			
M2,6x0,45	5.853				10.830			
3x0,35	5.853				10.830			
M3x0,50	4.738				8.179			
M3x0,60	4.738				8.179			
3,5x0,35	5.853				10.830			
M3,5x0,60	5.853				10.830			
4x0,35	5.853				10.830			
4x0,50	5.853				10.830			
M4x0,70	5.853				8.179			
M4x0,75	5.853				10.830			
M4,5x0,75	5.853				10.830			
5X0,50	5.853	9.721			10.830	17.035		
M5x0,75	5.853	9.721			10.830	17.035		
M5x0,80	4.738	9.721			8.179	17.035		
M5x0,85	5.853	9.721			10.830	17.035		
M5x0,90	5.853	9.721			10.830	17.035		
M5,5x0,90	5.853	9.721			10.830	17.035		
6x0,50	5.853	9.721			10.830	17.035		
6x0,75	5.853	9.721			10.830	17.035		
M6x1,00	4.738	7.487	19.786		8.179	13.076	34.067	
7x0,50	5.853	9.721	19.786		10.830	17.035	34.067	
7x0,75	5.853	9.721	19.786		10.830	17.035	34.067	
M7x1,00	4.738	7.487	19.786		8.179	13.076	34.067	
8x0,50	5.853	9.721	19.786		10.830	17.035	34.067	
8x0,75	5.853	9.721	19.786		10.830	17.035	34.067	
8x1,00	4.738	7.487	19.786		8.179	13.076	34.067	
M8x1,25	4.738	7.487	19.786		8.179	13.076	34.067	
8x1,50	5.853	9.721	19.786		10.830	13.076	34.067	
9x0,50	5.853	9.721	19.786		10.830	17.035	34.067	
9x0,75	5.853	9.721	19.786		10.830	17.035	34.067	
9x1,00	4.738	7.487	15.224		8.179	13.076	26.670	
M9x1,25	4.738	7.487	15.224		8.179	13.076	26.670	
9x1,50	5.853	9.721	19.786		10.830	17.035	34.067	
10x0,75	5.853	9.721	19.786		10.830	17.035	34.067	
10x1,00	5.853	7.487	15.224		10.830	13.076	26.670	
10x1,25	5.853	7.487	15.224		10.830	13.076	26.670	
M10x1,50	5.853	7.487	15.224		10.830	13.076	26.670	
10x1,75	5.853	9.721	19.786		10.830	17.035	34.067	
11x0,75	5.853	9.721	19.786		10.830	17.035	34.067	
11x1,00	5.853	7.487	15.224		10.830	13.076	26.670	
11x1,25	5.853	7.487	15.224		10.830	13.076	26.670	
M11x1,50	5.853	7.487	15.224		10.830	13.076	26.670	
12x0,75	5.853	9.721	19.786		10.830	17.035	34.067	
12x1,00	5.853	7.487	15.224		10.830	13.076	26.670	
12x1,25	5.853	7.487	15.224		10.830	13.076	26.670	
12x1,50	5.853	7.487	15.224		10.830	13.076	26.670	
M12x1,75	5.853	7.487	15.224		10.830	13.076	26.670	
13x1,00		9.721	19.786			17.035	34.067	
13x1,25		9.721	19.786			17.035	34.067	
13x1,50		9.721	19.786			17.035	34.067	
M13x1,75		9.721	19.786			17.035	34.067	
14x1,00		7.487	15.224			13.076	26.670	
14x1,25		7.487	15.224			13.076	26.670	
14x1,50		7.487	15.224			13.076	26.670	
14x1,75		9.721	19.786			17.035	34.067	
M14x2,00		7.487	15.224			13.076	26.670	
15x1,00		9.721	15.224			17.035	34.067	
15x1,25		9.721	19.786			17.035	34.067	
15x1,50		9.721	19.786			17.035	34.067	
15x1,75		9.721	19.786			17.035	34.067	
M15x2,00		9.721	19.786			17.035	34.067	
16x0,75		9.721	19.786			17.035	34.067	
16x1,00		7.487	15.224			13.076	26.670	
16x1,25		7.487	15.224			13.076	26.670	
16x1,50		7.487	15.224			13.076	26.670	



16x1,75		9.721	19.786			17.035	34.067	
M16x2,00		7.487	15.224			13.076	26.670	
17x1,00		9.721	19.786			17.035	34.067	
17x1,25		9.721	19.786			17.035	34.067	
17x1,50		9.721	19.786			17.035	34.067	
17x1,75		9.721	19.786			17.035	34.067	
17x2,00		9.721	19.786			17.035	34.067	
18x1,00		7.487	15.224			13.076	26.670	
18x1,25		9.721	19.786			17.035	34.067	
18x1,50		7.487	15.224			13.076	26.670	
18x1,75		9.721	19.786			17.035	34.067	
18x2,00		9.721	19.786			17.035	34.067	
M18x2,50		7.487	15.224			13.076	26.670	
19x1,00		9.721	19.786			17.035	34.067	
19x1,50		9.721	19.786			17.035	34.067	
20x1,00		9.721	15.224			17.035	26.670	
20x1,25		9.721	15.224			17.035	26.670	
20x1,50		9.721	15.224			17.035	26.670	
20x2,00		9.721	15.224			17.035	26.670	
M20x2,50		9.721	15.224			17.035	26.670	
M21x2,50			19.786				34.067	
22x1,00			15.224				26.670	
22x1,50			15.224				26.670	
22x2,00			15.224				26.670	
M22x2,50			15.224				26.670	
23x1,00			25.721				26.670	
23x1,50			25.721				26.670	
24x1,00			15.224				26.670	
24x1,50			15.224				26.670	
24x2,00			15.224				26.670	
M24x3,00			15.224				26.670	
25x1,00			25.721				34.067	
25x1,50			25.721				34.067	
25x2,00			25.721				34.067	
M25x3,00			19.786				34.067	
26x1,00			19.786	36.575			34.067	63.744
26x1,50			19.786	36.575			34.067	63.744
26x2,00			19.786	36.575			34.067	63.744
M26x3,00			19.786	36.575			34.067	63.744
27x1,00			25.721	46.881			34.067	82.832
27x1,50			25.721	46.881			34.067	82.832
27x2,00			25.721	46.881			34.067	82.832
27x2,50			19.786	46.881			34.067	82.832
M27x3,00			19.786	36.575			34.067	63.744
28x1,00			19.786	36.575			34.067	63.744
28x1,50			19.786	36.575			34.067	63.744
28x2,00			19.786	36.575			34.067	63.744
30x1,50				36.575				63.744
30x2,00				36.575				63.744
M30x3,50				36.575				63.744
32x1,50				36.575				63.744
32x2,00				36.575				63.744
M32x3,50				36.575				63.744
33x1,50				46.881				82.832
33x2,00				46.881				82.832
M33x3,50				36.575				63.744
34x1,50				36.575				63.744
34x2,00				36.575				63.744
M34x3,50				36.575				63.744
35x1,50				46.881				82.832
35x2,00				46.881				82.832
M35x3,50				36.575				63.744
36x1,50				36.575				63.744
36x2,00				36.575				63.744
M36x4,00				46.881				82.832

COJINETES REDONDOS PARA HACER ROSCAS CON TORNILLO DE REGISTRO

BSW								
BSW	ACERO AL CARBONO				ACERO RÁPIDO			
Medida	Ø 1"	Ø 1 1/2"	Ø 2"	Ø 2 1/2"	Ø 1"	Ø 1 1/2"	Ø 2"	Ø 2 1/2"
1/16-60	5.853				10.830			
3/32-48	5.853				10.830			
.1/8-40	4.738				8.179			
5/32-32	4.738				8.179			
3/16-24	4.738	9.721			8.179	17.035		
7/32-24	4.738	9.721			8.179	17.035		
.1/4-20	4.738	7.487	19.786		8.179	13.076	34.067	
5/16-18	4.738	7.487	19.786		8.179	13.076	34.067	
.3/8-16	4.738	7.487	15.224		8.179	13.076	26.670	
7/16-14	5.853	7.487	15.224		10.830	13.076	26.670	
.1/2-12	5.853	7.487	15.224		10.830	13.076	26.670	
9/16-12		7.487	15.224			13.076	26.670	
.5/8-11		7.487	15.224			13.076	26.670	
11/16-11		9.721	19.786			17.035	34.067	
.3/4-10		7.487	15.224			13.076	26.670	
13/16-10			19.786				34.067	
.7/8-9			15.224				26.670	
15/16-9			19.786				34.067	
1" - 8			15.224	36.575			26.670	82.832
1" 1/8-7			19.786	36.575			34.067	63.744
1" 1/4-7				36.575				63.744
1" 3/8-6				36.575				63.744
1" 1/2-6				46.881				82.832
BSP								
BSP	ACERO AL CARBONO				ACERO RÁPIDO			
Medida	Ø 1"	Ø 1 1/2"	Ø 2"	Ø 2 1/2"	Ø 1"	Ø 1 1/2"	Ø 2"	Ø 2 1/2"
.1/8-28	5.853	7.487	15.224		8.179	13.076	26.670	
.1/4-19		7.487	15.224			13.076	26.670	
.3/8-19		7.487	15.224			13.076	26.670	
.1/2-14		9.721	15.224			17.035	26.670	
.5/8-14			15.224				26.670	
.3/4-14			15.224	36.575			26.670	63.744
.7/8-14				36.575				63.744
1" -11				36.575				63.744
1" 1/4-11				46.881				82.832
BSC								
BSC	ACERO AL CARBONO				ACERO RÁPIDO			
Medida	Ø 1"	Ø 1 1/2"	Ø 2"	Ø 2 1/2"	Ø 1"	Ø 1 1/2"	Ø 2"	Ø 2 1/2"
.1/2-18	5.853	9.721	19.786		10.830	17.035	34.067	
.5/8-18		9.721	19.786			17.035	34.067	
.3/4-16		9.721	19.786			17.035	34.067	
.7/8-16			19.786				34.067	
1" - 16			19.786	46.881			34.067	82.832
1" 1/8-16			19.786	46.881			34.067	82.832
1" 1/4-16				46.881				82.832
1" 1/2-16				46.881				82.832
BSB								
BSB	ACERO AL CARBONO				ACERO RÁPIDO			
Medida	Ø 1"	Ø 1 1/2"	Ø 2"	Ø 2 1/2"	Ø 1"	Ø 1 1/2"	Ø 2"	Ø 2 1/2"
3/16-26	5.853				10.830			
.1/4-26	5.853	9.721	19.786		10.830	17.035	44.287	
5/16-26	5.853	9.721	19.786		10.830	17.035	44.287	
.3/8-26	5.853	9.721	19.786		10.830	17.035	34.067	
7/16-26	5.853	9.721	19.786		10.830	17.035	34.067	
.1/2-26	5.853	9.721	19.786		10.830	17.035	34.067	
9/16-26		9.721	19.786			17.035	34.067	
.5/8-26		9.721	19.786			17.035	34.067	
11/16-26		9.721	19.786			17.035	44.287	
.3/4-26		9.721	19.786			17.035	34.067	
.7/8-26			19.786				34.067	
1" - 26			19.786	46.881			34.067	82.832
1" 1/8-26			19.786	46.881			44.287	82.832
1" 1/4-26				46.881				82.832
1" 1/2-26				46.881				82.832
BSF								
BSF	ACERO AL CARBONO				ACERO RÁPIDO			
Medida	Ø 1"	Ø 1 1/2"	Ø 2"	Ø 2 1/2"	Ø 1"	Ø 1 1/2"	Ø 2"	Ø 2 1/2"
3/16-32	5.853				10.830			



7/32-28	5.853				10.830			
.1/4-26	5.853	9.721	19.786		10.830	17.035	44.287	
5/16-22	5.853	9.721	19.786		10.830	17.035	44.287	
.3/8-20	5.853	9.721	19.786		10.830	17.035	34.067	
.7/16-18	5.853	9.721	19.786		10.830	17.035	34.067	
.1/2-16	5.853	9.721	19.786		10.830	17.035	34.067	
9/16-16		9.721	19.786			17.035	34.067	
.5/8-14		9.721	19.786			17.035	34.067	
11/16-14		9.721	19.786			17.035	44.287	
.3/4-12		9.721	19.786			17.035	34.067	
13/16-12			19.786				44.287	
.7/8-11			19.786				34.067	
1" - 10			19.786	46.881			34.067	82.832
1" 1/8-9			19.786	46.881			44.287	82.832
1" 1/4-9				46.881				82.832
1" 3/8-8				46.881				82.832
1" 1/2-8				46.881				82.832

NPT

NPT	ACERO AL CARBONO				ACERO RÁPIDO			
Medida	Ø 1"	Ø 1 1/2"	Ø 2"	Ø 2 1/2"	Ø 1"	Ø 1 1/2"	Ø 2"	Ø 2 1/2"
.1/8-27	7.487	12.644	25.890		13.076	22.715	45.171	
.1/4-18		12.644	25.890			22.715	45.171	
.3/8-18		12.644	25.890			22.715	45.171	
.1/2-14		12.644	25.890			22.715	45.171	
.5/8-14			25.890				45.171	
.3/4-14			25.890	29.438			45.171	
.7/8-14				60.221				#####
1" - 11 1/2				60.221				#####
1"-1/4 x 11,5				60.221				#####

UNC

UNC	ACERO AL CARBONO				ACERO RÁPIDO			
Medida	Ø 1"	Ø 1 1/2"	Ø 2"	Ø 2 1/2"	Ø 1"	Ø 1 1/2"	Ø 2"	Ø 2 1/2"
Nº 4-40	5.853				10.830			
Nº 5-40	5.853				10.830			
Nº 6-32	5.853				10.830			
Nº 8-32	5.853				10.830			
Nº 10-24	5.853	9.721			10.830	17.035		
Nº 12-24	5.853	9.721			10.830	17.035		
.1/4-20	5.853	9.721	19.786		10.830	17.035	34.067	
5/16-18	5.853	9.721	19.786		10.830	17.035	34.067	
.3/8-16	5.853	9.721	19.786		10.830	17.035	34.067	
.7/16-14	5.853	9.721	19.786		10.830	17.035	34.067	
.1/2-13	5.853	9.721	19.786		10.830	17.035	34.067	
9/16-12		9.721	19.786			17.035	34.067	
.5/8-11		9.721	19.786			17.035	34.067	
11/16-11		9.721	19.786			17.035	34.067	
.3/4-10		9.721	19.786			17.035	34.067	
.7/8-9			19.786				34.067	
1" - 8			19.786	46.881			34.067	82.832
1" 1/8-7			25.723	46.881			34.067	82.832
1" 1/4-7				46.881				82.832
1" 3/8-6				46.881				82.832
1" 1/2-6				46.881				82.832

UNEF

UNEF	ACERO AL CARBONO				ACERO RÁPIDO			
Medida	Ø 1"	Ø 1 1/2"	Ø 2"	Ø 2 1/2"	Ø 1"	Ø 1 1/2"	Ø 2"	Ø 2 1/2"
Nº 12-32	5.853				10.830			
.1/4-32	5.853	9.721	25.723		10.830	17.035	34.067	
5/16-32	5.853	9.721	25.723		10.830	17.035	34.067	
.3/8-32	5.853	9.721	19.786		10.830	17.035	34.067	
.7/16-28	5.853	9.721	19.786		10.830	17.035	34.067	
.1/2-28	5.853	9.721	19.786		10.830	17.035	34.067	
9/16-24		9.721	19.786			17.035	34.067	
.5/8-24		9.721	19.786			17.035	34.067	
11/16-24		9.721	25.723			17.035	34.067	
.3/4-20		9.721	19.786			17.035	34.067	
13/16-20			25.723				34.067	
.7/8-20			19.786				34.067	
15/16-20			25.723				34.067	
1" - 20			19.786	46.881			34.067	82.832
1" 1/8-18			25.723	46.881			34.067	82.832
1" 3/16-18				46.881				82.832
1" 1/4-18				46.881				82.832



1" 5/16-18			46.881			82.832
1" 3/8-18			46.881			82.832
1" 7/16-18			46.881			82.832
1" 1/2-18			46.881			82.832



COJINETES REDONDOS PARA HACER ROSCAS CON TORNILLO DE REGISTRO								
BSPT								
BSPT	ACERO AL CARBONO				ACERO RÁPIDO			
Medida	Ø 1"	Ø 1 1/2"	Ø 2"	Ø 2 1/2"	Ø 1"	Ø 1 1/2"	Ø 2"	Ø 2 1/2"
.1/8-28	7.487	12.644	25.890		13.076	22.715	45.171	
.1/4-19		12.644	25.890			22.715	45.171	
.3/8-19		12.644	25.890			22.715	45.171	
.1/2-14		12.644	25.890			22.715	45.171	
.5/8-14			25.890				45.171	
.3/4-14			25.890	60.221			45.171	106.168
.7/8-14				60.221				106.168
1" -11				60.221				106.168
1" 1/4-11				60.221				106.168
NPS								
NPS	ACERO AL CARBONO				ACERO RÁPIDO			
Medida	Ø 1"	Ø 1 1/2"	Ø 2"	Ø 2 1/2"	Ø 1"	Ø 1 1/2"	Ø 2"	Ø 2 1/2"
.1/8-27	5.853	9.721	19.786		10.830	17.035	34.067	
.1/4-18		9.721	19.786			17.035	34.067	
.3/8-18		9.721	19.786			17.035	34.067	
.1/2-14		9.721	19.786			17.035	34.067	
.5/8-14			19.786				34.067	
.3/4-14			19.786	46.881			34.067	82.832
.7/8-14				46.881				82.832
1" -11 1/2				46.881				82.832
UNF								
UNF	ACERO AL CARBONO				ACERO RÁPIDO			
Medida	Ø 1"	Ø 1 1/2"	Ø 2"	Ø 2 1/2"	Ø 1"	Ø 1 1/2"	Ø 2"	Ø 2 1/2"
Nº 4-48	5.853				10.830			
Nº 5-44	4.738				8.179			
Nº 6-40	4.738				8.179			
Nº 8-36	4.738				8.179			
Nº10-32	4.738	9.721			8.179	17.035		
Nº12-28	4.738	9.721			8.179	17.035		
.1/4-28	4.738	7.487	19.786		8.179	13.076	34.067	
5/16-24	4.738	7.487	19.786		8.179	13.076	34.067	
.3/8-24	4.738	7.487	15.224		8.179	13.076	26.670	
.7/16-20	5.853	7.487	15.224		10.830	13.076	26.670	
.1/2-20	5.853	7.487	15.224		10.830	13.076	26.670	
9/16-18		7.487	15.224			13.076	26.670	
.5/8-18		7.487	15.224			13.076	26.670	
11/16-18 NS		9.721	19.786			17.035	34.067	
.3/4-16		7.487	15.224			13.076	26.670	
13/16-16			19.786				34.067	
.7/8-14			15.224				26.670	
15/16-14			19.786				34.067	
1" -12			15.224	46.881			26.670	82.832
1" 1/8-12			19.786	36.575			34.067	63.744
1" 1/4-12				36.575				63.744
1" 3/8-12				36.575				63.744
1" 1/2-12				46.881				82.832

COJINETES REDONDOS PARA HACER ROSCAS CON TORNILLO DE REGISTRO

UN

Medida	ACERO AL CARBONO				ACERO RÁPIDO			
	Ø 1"	Ø 1 1/2"	Ø 2"	Ø 2 1/2"	Ø 1"	Ø 1 1/2"	Ø 2"	Ø 2 1/2"
5/16-20	5.853	9.721	12.573		10.830	17.035	44.287	
5/16-28	5.853	9.721	12.573		10.830	17.035	44.287	
.3/8-20	5.853	9.721	19.786		10.830	17.035	44.287	
.3/8-28	5.853	9.721	19.786		10.830	17.035	44.287	
7/16-16	7.608	9.721	19.786		14.079	17.035	44.287	
7/16-32	7.608	9.721	19.786		14.079	17.035	44.287	
.1/2-16	7.608	9.721	19.786		14.079	17.035	44.287	
.1/2-32	7.608	9.721	19.786		14.079	17.035	44.287	
9/16-16		9.721	19.786			17.035	44.287	
9/16-20		9.721	19.786			17.035	44.287	
9/16-28		9.721	19.786			17.035	44.287	
9/16-32		9.721	19.786			17.035	44.287	
.5/8-12		9.721	19.786			17.035	44.287	
.5/8-16		9.721	19.786			17.035	44.287	
.5/8-20		9.721	19.786			17.035	44.287	
.5/8-28		9.721	19.786			17.035	44.287	
.5/8-32		9.721	19.786			17.035	44.287	
11/16-12		9.721	19.786			17.035	44.287	
11/16-16		9.721	19.786			17.035	44.287	
11/16-20		9.721	19.786			17.035	44.287	
11/16-28		9.721	19.786			17.035	44.287	
11/16-32		9.721	19.786			17.035	44.287	
.3/4-12		9.721	19.786			17.035	44.287	
.3/4-28		9.721	19.786			17.035	44.287	
.3/4-32		9.721	19.786			17.035	44.287	
13/16-12			12.573				44.287	
13/16-16			12.573				44.287	
13/16-28			12.573				44.287	
13/16-32			12.573				44.287	
.7/8-12			19.786				34.067	
.7/8-16			19.786				34.067	
.7/8-28			19.786				34.067	
.7/8-32			19.786				34.067	
15/16-12			12.573				44.287	
15/16-16			12.573				44.287	
15/16-28			12.573				44.287	
15/16-32			12.573				44.287	
1" - 16			19.786	46.881			34.067	63.744
1" - 18			19.786	46.881			34.067	63.744
1" - 32			19.786	46.881			44.287	63.744
1" 1/16-8			12.573	46.881			44.287	63.744
1" 1/16-12			12.573	46.881			44.287	63.744
1" 1/16-16			12.573	46.881			44.287	63.744
1" 1/16-20			12.573	46.881			44.287	63.744
1" 1/16-28			12.573	46.881			44.287	63.744
1" 1/8-8			12.573	46.881			44.287	63.744
1" 1/8-16			12.573	46.881			44.287	63.744
1" 1/8-20			12.573	46.881			44.287	63.744
1" 1/8-28			12.573	46.881			44.287	63.744
1" 3/16-8			12.573	46.881			44.287	63.744
1" 3/16-12			12.573	46.881			44.287	63.744
1" 3/16-16			12.573	46.881			44.287	63.744
1" 3/16-20			12.573	46.881			44.287	63.744
1" 3/16-28			12.573	46.881			44.287	63.744
1" 1/4-8				46.881				63.744
1" 1/4-16				46.881				63.744



1" 1/4-20				46.881			63.744
1" 1/4-28				46.881			63.744
1" 5/16-8				46.881			63.744
1" 5/16-12				46.881			63.744
1" 5/16-16				46.881			63.744
1" 5/16-20				46.881			63.744
1" 5/16-28				46.881			63.744
1" 3/8-8				46.881			63.744
1" 3/8-16				46.881			63.744
1" 3/8-20				46.881			63.744
1" 3/8-28				46.881			63.744
1" 7/16-6				60.945			82.867
1" 7/16-8				60.945			82.867
1" 7/16-12				60.945			82.867
1" 7/16-16				60.945			82.867
1" 7/16-20				60.945			82.867
1" 7/16-28				60.945			82.867
1" 1/2-8				60.945			82.867
1" 1/2-16				60.945			82.867
1" 1/2-20				60.945			82.867
1" 1/2-28				60.945			82.867



COJINETES REDONDOS PARA HACER ROSCAS CON TORNILLO DE REGISTRO

UNS								
Medida	ACERO AL CARBONO				ACERO RÁPIDO			
	Ø 1"	Ø 1 1/2"	Ø 2"	Ø 2 1/2"	Ø 1"	Ø 1 1/2"	Ø 2"	Ø 2 1/2"
.1/4-24	5.853	9.721			10.830	17.035		
.1/4-27	5.853	9.721			10.830	17.035		
.1/4-36	5.853	9.721			10.830	17.035		
.1/4-40	5.853	9.721			10.830	17.035		
.1/4-48	5.853	9.721			10.830	17.035		
.1/4-56	5.853	9.721			10.830	17.035		
5/16-27	5.853	9.721			10.830	17.035		
5/16-36	5.853	9.721			10.830	17.035		
5/16-40	5.853	9.721			10.830	17.035		
5/16-48	5.853	9.721			10.830	17.035		
.3/8-18	5.853	9.721	19.786		10.830	17.035	34.067	
.3/8-27	5.853	9.721	19.786		10.830	17.035	34.067	
.3/8-36	5.853	9.721	19.786		10.830	17.035	34.067	
.3/8-40	5.853	9.721	19.786		10.830	17.035	34.067	
7/16-18	7.608	9.721	19.786		14.079	17.035	34.067	
7/16-24	7.608	9.721	19.786		14.079	17.035	34.067	
7/16-27	7.608	9.721	19.786		14.079	17.035	34.067	
.1/2-12	7.608	9.721	19.786		14.079	17.035	34.067	
.1/2-14	7.608	9.721	19.786		14.079	17.035	34.067	
.1/2-18	7.608	9.721	19.786		14.079	17.035	34.067	
.1/2-24	7.608	9.721	19.786		14.079	17.035	34.067	
.1/2-27	7.608	9.721	19.786		14.079	17.035	34.067	
9/16-14		9.721	19.786			17.035	34.067	
9/16-27		9.721	19.786			17.035	34.067	
.5/8-14		9.721	19.786			17.035	34.067	
.5/8-27		9.721	19.786			17.035	34.067	
.3/4-14		9.721	19.786			17.035	34.067	
.3/4-18		9.721	19.786			17.035	34.067	
.3/4-24		9.721	19.786			17.035	34.067	
.3/4-27		9.721	19.786			17.035	34.067	
.7/8-10			19.786				34.067	
.7/8-18			19.786				34.067	
.7/8-24			19.786				34.067	
.7/8-27			19.786				34.067	
1" -10			19.786	60.945			34.067	82.867

1" -14			19.786	60.945			34.067	82.867
1" -18			19.786	60.945			34.067	82.867
1" -24			19.786	60.945			34.067	82.867
1" -27			19.786	60.945			34.067	82.867
1" 1/8-10			12.573	46.881			44.287	63.744
1" 1/8-14			12.573	46.881			44.287	63.744
1" 1/8-24			12.573	46.881			44.287	63.744
1" 1/4-10				46.881				63.744
1" 1/4-14				46.881				63.744
1" 1/4-24				46.881				63.744
1" 3/8-10				46.881				63.744
1" 3/8-14				46.881				63.744
1" 3/8-24				46.881				63.744
1" 1/2-10				60.945				82.867
1" 1/2-14				60.945				82.867
1" 1/2-24				60.945				82.867

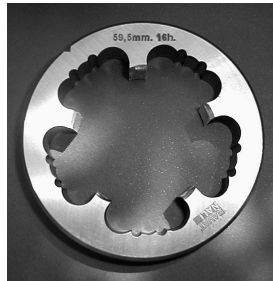

COJINETES ESPECIALES HASTA DIÁMETRO EXTERIOR 6"								
Ø EXTERIOR		Ø DE LA ROSCA mm.	Espesor	PRECIO			PRECIO	
Ø"	mm			carbono	RAPIDO	Espesor	carbono	RAPIDO
3"	76,20	Desde 34 hasta 43 mm.	18 mm	67.226	96.037	25 mm	88.996	127.136
3 1/2"	88,90	Desde 38 hasta 50 mm.	18 mm	106.039	151.484	25 mm	139.173	198.820
4"	101,60	Desde 40 hasta 57 mm.	20 mm	155.078	221.541	30 mm	201.661	288.086
4 1/2"	114,30	Desde 43 hasta 64 mm.	20 mm	225.708	322.441	36 mm	293.306	419.011
5"	127,00	Desde 48 hasta 71 mm.	22 mm	310.349	443.356	36 mm	403.318	576.169
5 1/2"	139,70	Desde 52 hasta 78 mm.	22 mm	395.743	565.348	38 mm	513.896	734.138
6"	152,40	Desde 57 hasta 85 mm.	22 mm	493.828	705.468	38 mm	641.904	917.005

OBSERVACIONES:

Los diámetros que se encuentren por encima y/o por debajo de los indicados en la columna "diámetro exterior", así como las medidas con rosca IZQUIERDA sufrirán un recargo del 25 %.

Las medidas cónicas 1:16 sufrirán un recargo del 35 %.

Las demás piezas de fabricación especial, serán cotizadas de acuerdo al diseño requerido por el cliente.

Cojinetes norma DIN 223 (EN 22586)

EXTERIOR D	ESPESOR H	SUJECIÓN	
		LATERAL	FRONTAL
16 mm	5 mm	23.927	31.104
20 mm	5 mm	16.449	21.384
20 mm	7 mm	17.348	22.552
25 mm	9 mm	17.945	23.328
30 mm	11 mm	23.927	31.104
38 mm	10 mm	26.320	34.216
38 mm	14 mm	26.917	34.993
45 mm	14 mm	41.871	54.433
45 mm	18 mm	47.853	62.209
55 mm	15 mm	75.967	98.757
55 mm	22 mm	84.940	110.421
65 mm	18 mm	104.678	136.082
65 mm	25 mm	113.651	147.746

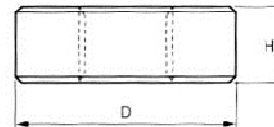

Los valores mencionados en esta lista de precios, pueden sufrir variaciones por diferencias de redondeo con el sistema de facturación.

RAVAT NALI S.R.L.

Triunvirato 2752 – (B1753GQV)
V. Luzuriaga – Pcia. De Buenos Aires
República Argentina
Tel.: 54 (11) 4659-2695



+541152486181

www.ravatnali.com

cojinetes@ravatnali.com