

LISTA DE PRECIOS COMPLETA FEBRERO 2023

RAVAT NALI S.R.L.

Triunvirato 2752 – (B1753GQV)

V. Luzuriaga – La Matanza

Pcia. De Buenos Aires - República Argentina

Tel.: 54 (11) 4659-2695



+541152486181



Los valores mencionados en esta lista de precios, pueden sufrir variaciones por diferencias de redondeo con el sistema de facturación.

MACHOS ACERO AL CARBONO												
POR UNIDAD												
BSP	\$											
1/8 x 28	2.371											
1/4 x 19	3.560											
3/8 x 19	4.460											
1/2 x 14	6.060											
Juego por 3 piezas		Machos sueltos										
MM s. i.	\$	cono 2										
		10	unid.	\$								
M 3 x 0,50	1.671	10	unid.	5.571								
M 4 x 0,70	1.671	10	unid.	5.571								
M 5 x 0,80	1.811	10	unid.	6.035								
M 6 x 1,00	2.227	10	unid.	7.422								
M 7 x 1,00	2.300	10	unid.	7.665								
M 8 x 1,25	2.434	10	unid.	8.113								
M 9 x 1,25	2.855	10	unid.	9.517								
M10 x 1,50	2.855	10	unid.	9.517								
M11 x 1,50	3.626	10	unid.	12.087								
M12 x 1,75	3.626	10	unid.	12.087								
M14 x 2,00	4.392	10	unid.	14.640								
M16 x 2,00	6.624	5	unid.	11.040								
M18 x 2,50	7.042	5	unid.	11.736								
M20 x 2,50	10.591	5	unid.	17.652								
Juego por 3 piezas		Machos sueltos										
MF	\$	cono 2										
		x		\$								
8 x 1,00	2.649											
9 x 1,00	2.930											
10 x 1,00	3.276	10	unid.	10.921								
10 x 1,25	3.276	10	unid.	10.921								
11 x 1,00	4.042											
11 x 1,25	4.042											
12 x 1,00	4.042	10	unid.	13.474								
12 x 1,25	4.042	10	unid.	13.474								
12 x 1,50	4.042	10	unid.	13.474								
14 x 1,00	4.942											
14 x 1,25	4.942											
14 x 1,50	4.942											
16 x 1,00	7.947											
16 x 1,50	7.947											
18 x 1,00	9.963											
18 x 1,50	9.963											
20 x 1,00	12.052											
20 x 1,50	12.052											
Juego por 3 piezas		Machos sueltos										
BSW	\$	cono 2										
		10 <th style="background-color: #0070c0; color: white;">unid. <th style="background-color: #0070c0; color: white;">\$</th> </th>	unid. <th style="background-color: #0070c0; color: white;">\$</th>	\$								
1/8 x 40	1.671	10	unid.	5.571								
5/32 x 32	1.671	10	unid.	5.571								
3/16 x 24	1.671	10	unid.	5.571								
7/32 x 24	1.811	10	unid.	6.035								
1/4 x 20	1.811	10	unid.	6.035								
5/16 x 18	2.021	10	unid.	6.737								
3/8 x 16	2.371	10	unid.	7.903								
7/16 x 14	3.082	10	unid.	10.274								
1/2 x 12	3.082	10	unid.	10.274								
9/16 x 12	4.392	5	unid.	7.320								
5/8 x 11	5.297	5	unid.	8.829								
3/4 x 10	9.479	5	unid.	15.798								
Juego por 3 piezas		Machos sueltos										
UNC	\$	cono 2										
		10	piezas	\$								
Nº 6 x 32	1.262	10	piezas	4.207								
1/4 x 20	2.300	X	X	X								
5/16 x 18	2.577	X	X	X								
3/8 x 16	3.082	X	X	X								
7/16 x 14	4.042	X	X	X								
1/2 x 13	4.460	10	unid.	14.867								
9/16 x 12	5.500	X	X	X								
5/8 x 11	7.947	X	X	X								
3/4 x 10	12.684	X	X	X								
Juego por 3 piezas		Machos sueltos										
UNF	\$	cono 2										
		x	x	x								
Nº 5 x 44	1.844	x	x	x								
Nº 8 x 36	1.844	x	x	x								
Nº 10 x 32	1.844	x	x	x								
Nº 12 x 28	2.021	x	x	x								
1/4 x 28	2.021	10	unid.	7.074								
5/16 x 24	2.300	10	unid.	8.049								
3/8 x 24	2.716	10	unid.	9.505								
7/16 x 20	3.626	10	unid.	12.691								
1/2 x 20	3.626	10	unid.	12.691								
9/16 x 18	4.805	5	unid.	7.207								
5/8 x 18	5.921	5	unid.	8.881								
3/4 x 16	10.998	5	unid.	16.496								



COJINETES REDONDOS PARA HACER ROSCAS CON TORNILLO DE REGISTRO

MM	ACERO AL CARBONO				ACERO RÁPIDO				
	Medida	Ø 1"	Ø 1 1/2"	Ø 2"	Ø 2 1/2"	Ø 1"	Ø 1 1/2"	Ø 2"	Ø 2 1/2"
2x0,25	4.744					8.777			
M2x0,40	4.744					8.777			
2,3x0,25	4.744					8.777			
M2,3x0,40	4.744					8.777			
M2,5x0,45	4.744					8.777			
2,6x0,35	4.744					8.777			
M2,6x0,45	4.744					8.777			
3x0,35	4.744					8.777			
M3x0,50	3.840					6.629			
M3x0,60	3.840					6.629			
3,5x0,35	4.744					8.777			
M3,5x0,60	4.744					8.777			
4x0,35	4.744					8.777			
4x0,50	4.744					8.777			
M4x0,70	4.744					6.629			
M4x0,75	4.744					8.777			
M4,5x0,75	4.744					8.777			
5X0,50	4.744	7.879				8.777	13.806		
M5x0,75	4.744	7.879				8.777	13.806		
M5x0,80	3.840	7.879				6.629	13.806		
M5x0,85	4.744	7.879				8.777	13.806		
M5x0,90	4.744	7.879				8.777	13.806		
M5,5x0,90	4.744	7.879				8.777	13.806		
6x0,50	4.744	7.879				8.777	13.806		
6x0,75	4.744	7.879				8.777	13.806		
M6x1,00	3.840	6.068	16.036			6.629	10.598	27.611	
7x0,50	4.744	7.879	16.036			8.777	13.806	27.611	
7x0,75	4.744	7.879	16.036			8.777	13.806	27.611	
M7x1,00	3.840	6.068	16.036			6.629	10.598	27.611	
8x0,50	4.744	7.879	16.036			8.777	13.806	27.611	
8x0,75	4.744	7.879	16.036			8.777	13.806	27.611	
8x1,00	3.840	6.068	16.036			6.629	10.598	27.611	
M8x1,25	3.840	6.068	16.036			6.629	10.598	27.611	
8x1,50	4.744	7.879	16.036			8.777	10.598	27.611	
9x0,50	4.744	7.879	16.036			8.777	13.806	27.611	
9x0,75	4.744	7.879	16.036			8.777	13.806	27.611	
9x1,00	3.840	6.068	12.339			6.629	10.598	21.615	
M9x1,25	3.840	6.068	12.339			6.629	10.598	21.615	
9x1,50	4.744	7.879	16.036			8.777	13.806	27.611	
10x0,75	4.744	7.879	16.036			8.777	13.806	27.611	
10x1,00	4.744	6.068	12.339			8.777	10.598	21.615	
10x1,25	4.744	6.068	12.339			8.777	10.598	21.615	
M10x1,50	4.744	6.068	12.339			8.777	10.598	21.615	
10x1,75	4.744	7.879	16.036			8.777	13.806	27.611	
11x0,75	4.744	7.879	16.036			8.777	13.806	27.611	
11x1,00	4.744	6.068	12.339			8.777	10.598	21.615	
11x1,25	4.744	6.068	12.339			8.777	10.598	21.615	
M11x1,50	4.744	6.068	12.339			8.777	10.598	21.615	
12x0,75	4.744	7.879	16.036			8.777	13.806	27.611	
12x1,00	4.744	6.068	12.339			8.777	10.598	21.615	
12x1,25	4.744	6.068	12.339			8.777	10.598	21.615	
12x1,50	4.744	6.068	12.339			8.777	10.598	21.615	
M12x1,75	4.744	6.068	12.339			8.777	10.598	21.615	
13x1,00		7.879	16.036				13.806	27.611	
13x1,25		7.879	16.036				13.806	27.611	
13x1,50		7.879	16.036				13.806	27.611	
M13x1,75		7.879	16.036				13.806	27.611	
14x1,00		6.068	12.339				10.598	21.615	
14x1,25		6.068	12.339				10.598	21.615	
14x1,50		6.068	12.339				10.598	21.615	
14x1,75		7.879	16.036				13.806	27.611	
M14x2,00		6.068	12.339				10.598	21.615	
15x1,00		7.879	12.339				13.806	27.611	
15x1,25		7.879	16.036				13.806	27.611	
15x1,50		7.879	16.036				13.806	27.611	
15x1,75		7.879	16.036				13.806	27.611	
M15x2,00		7.879	16.036				13.806	27.611	
16x0,75		7.879	16.036				13.806	27.611	
16x1,00		6.068	12.339				10.598	21.615	
16x1,25		6.068	12.339				10.598	21.615	
16x1,50		6.068	12.339				10.598	21.615	



16x1,75		7.879	16.036			13.806	27.611	
M16x2,00		6.068	12.339			10.598	21.615	
17x1,00		7.879	16.036			13.806	27.611	
17x1,25		7.879	16.036			13.806	27.611	
17x1,50		7.879	16.036			13.806	27.611	
17x1,75		7.879	16.036			13.806	27.611	
17x2,00		7.879	16.036			13.806	27.611	
18x1,00		6.068	12.339			10.598	21.615	
18x1,25		7.879	16.036			13.806	27.611	
18x1,50		6.068	12.339			10.598	21.615	
18x1,75		7.879	16.036			13.806	27.611	
18x2,00		7.879	16.036			13.806	27.611	
M18x2,50		6.068	12.339			10.598	21.615	
19x1,00		7.879	16.036			13.806	27.611	
19x1,50		7.879	16.036			13.806	27.611	
20x1,00		7.879	12.339			13.806	21.615	
20x1,25		7.879	12.339			13.806	21.615	
20x1,50		7.879	12.339			13.806	21.615	
20x2,00		7.879	12.339			13.806	21.615	
M20x2,50		7.879	12.339			13.806	21.615	
M21x2,50			16.036				27.611	
22x1,00			12.339				21.615	
22x1,50			12.339				21.615	
22x2,00			12.339				21.615	
M22x2,50			12.339				21.615	
23x1,00			20.846				21.615	
23x1,50			20.846				21.615	
24x1,00			12.339				21.615	
24x1,50			12.339				21.615	
24x2,00			12.339				21.615	
M24x3,00			12.339				21.615	
25x1,00			20.846				27.611	
25x1,50			20.846				27.611	
25x2,00			20.846				27.611	
M25x3,00			16.036				27.611	
26x1,00			16.036	29.643			27.611	51.663
26x1,50			16.036	29.643			27.611	51.663
26x2,00			16.036	29.643			27.611	51.663
M26x3,00			16.036	29.643			27.611	51.663
27x1,00			20.846	37.996			27.611	67.134
27x1,50			20.846	37.996			27.611	67.134
27x2,00			20.846	37.996			27.611	67.134
27x2,50			16.036	37.996			27.611	67.134
M27x3,00			16.036	29.643			27.611	51.663
28x1,00			16.036	29.643			27.611	51.663
28x1,50			16.036	29.643			27.611	51.663
28x2,00			16.036	29.643			27.611	51.663
30x1,50				29.643				51.663
30x2,00				29.643				51.663
M30x3,50				29.643				51.663
32x1,50				29.643				51.663
32x2,00				29.643				51.663
M32x3,50				29.643				51.663
33x1,50				37.996				67.134
33x2,00				37.996				67.134
M33x3,50				29.643				51.663
34x1,50				29.643				51.663
34x2,00				29.643				51.663
M34x3,50				29.643				51.663
35x1,50				37.996				67.134
35x2,00				37.996				67.134
M35x3,50				29.643				51.663
36x1,50				29.643				51.663
36x2,00				29.643				51.663
M36x4,00				37.996				67.134

COJINETES REDONDOS PARA HACER ROSCAS CON TORNILLO DE REGISTRO

BSW								
BSW	ACERO AL CARBONO				ACERO RÁPIDO			
Medida	Ø 1"	Ø 1 1/2"	Ø 2"	Ø 2 1/2"	Ø 1"	Ø 1 1/2"	Ø 2"	Ø 2 1/2"
1/16-60	4.744				8.777			
3/32-48	4.744				8.777			
.1/8-40	3.840				6.629			
5/32-32	3.840				6.629			
3/16-24	3.840	7.879			6.629	13.806		
7/32-24	3.840	7.879			6.629	13.806		
.1/4-20	3.840	6.068	16.036		6.629	10.598	27.611	
5/16-18	3.840	6.068	16.036		6.629	10.598	27.611	
.3/8-16	3.840	6.068	12.339		6.629	10.598	21.615	
7/16-14	4.744	6.068	12.339		8.777	10.598	21.615	
.1/2-12	4.744	6.068	12.339		8.777	10.598	21.615	
9/16-12		6.068	12.339			10.598	21.615	
.5/8-11		6.068	12.339			10.598	21.615	
11/16-11		7.879	16.036			13.806	27.611	
.3/4-10		6.068	12.339			10.598	21.615	
13/16-10			16.036				27.611	
.7/8-9			12.339				21.615	
15/16-9			16.036				27.611	
1" - 8			12.339	29.643			21.615	67.134
1" 1/8-7			16.036	29.643			27.611	51.663
1" 1/4-7				29.643				51.663
1" 3/8-6				29.643				51.663
1" 1/2-6				29.643				67.134
BSP								
BSP	ACERO AL CARBONO				ACERO RÁPIDO			
Medida	Ø 1"	Ø 1 1/2"	Ø 2"	Ø 2 1/2"	Ø 1"	Ø 1 1/2"	Ø 2"	Ø 2 1/2"
.1/8-28	4.744	6.068	12.339		6.629	10.598	21.615	
.1/4-19		6.068	12.339			10.598	21.615	
.3/8-19		6.068	12.339			10.598	21.615	
.1/2-14		7.879	12.339			13.806	21.615	
.5/8-14			12.339				21.615	
.3/4-14			12.339	29.643			21.615	51.663
.7/8-14				29.643				51.663
1" -11				29.643				51.663
1" 1/4-11				29.643				67.134
BSC								
BSC	ACERO AL CARBONO				ACERO RÁPIDO			
Medida	Ø 1"	Ø 1 1/2"	Ø 2"	Ø 2 1/2"	Ø 1"	Ø 1 1/2"	Ø 2"	Ø 2 1/2"
.1/2-18	4.744	7.879	16.036		8.777	13.806	27.611	
.5/8-18		7.879	16.036			13.806	27.611	
.3/4-16		7.879	16.036			13.806	27.611	
.7/8-16			16.036				27.611	
1" - 16			16.036	37.996			27.611	67.134
1" 1/8-16			16.036	37.996			27.611	67.134
1" 1/4-16				37.996				67.134
1" 1/2-16				38.086				67.134
BSB								
BSB	ACERO AL CARBONO				ACERO RÁPIDO			
Medida	Ø 1"	Ø 1 1/2"	Ø 2"	Ø 2 1/2"	Ø 1"	Ø 1 1/2"	Ø 2"	Ø 2 1/2"
3/16-26	4.744				8.777			
.1/4-26	4.744	7.879	16.036		8.777	13.806	35.894	
5/16-26	4.744	7.879	16.036		8.777	13.806	35.894	
.3/8-26	4.744	7.879	16.036		8.777	13.806	27.611	
7/16-26	4.744	7.879	16.036		8.777	13.806	27.611	
.1/2-26	4.744	7.879	16.036		8.777	13.806	27.611	
9/16-26		7.879	16.036			13.806	27.611	
.5/8-26		7.879	16.036			13.806	27.611	
11/16-26		7.879	16.036			13.806	35.894	
.3/4-26		7.879	16.036			13.806	27.611	
.7/8-26			16.036				27.611	
1" - 26			16.036	37.996			27.611	67.134
1" 1/8-26			16.036	37.996			35.894	67.134
1" 1/4-26				37.996				67.134
1" 1/2-26				37.996				67.134
BSF								
BSF	ACERO AL CARBONO				ACERO RÁPIDO			
Medida	Ø 1"	Ø 1 1/2"	Ø 2"	Ø 2 1/2"	Ø 1"	Ø 1 1/2"	Ø 2"	Ø 2 1/2"
3/16-32	4.744				8.777			



7/32-28	4.744				8.777			
.1/4-26	4.744	7.879	16.036		8.777	13.806	35.894	
5/16-22	4.744	7.879	16.036		8.777	13.806	35.894	
.3/8-20	4.744	7.879	16.036		8.777	13.806	27.611	
.7/16-18	4.744	7.879	16.036		8.777	13.806	27.611	
.1/2-16	4.744	7.879	16.036		8.777	13.806	27.611	
9/16-16		7.879	16.036			13.806	27.611	
.5/8-14		7.879	16.036			13.806	27.611	
11/16-14		7.879	16.036			13.806	35.894	
.3/4-12		7.879	16.036			13.806	27.611	
13/16-12			16.036				35.894	
.7/8-11			16.036				27.611	
1" - 10			16.036	37.996			27.611	67.134
1" 1/8-9			16.036	37.996			35.894	67.134
1" 1/4-9				37.996				67.134
1" 3/8-8				37.996				67.134
1" 1/2-8				37.996				67.134

NPT

NPT	ACERO AL CARBONO				ACERO RÁPIDO			
Medida	Ø 1"	Ø 1 1/2"	Ø 2"	Ø 2 1/2"	Ø 1"	Ø 1 1/2"	Ø 2"	Ø 2 1/2"
.1/8-27	6.068	10.248	20.984		10.598	18.410	36.610	
.1/4-18		10.248	20.984			18.410	36.610	
.3/8-18		10.248	20.984			18.410	36.610	
.1/2-14		10.248	20.984			18.410	36.610	
.5/8-14			20.984				36.610	
.3/4-14			20.984	29.438			36.610	
.7/8-14				48.808				86.047
1" - 11 1/2				48.808				86.047
1"-1/4 x 11,5				29.438				

UNC

UNC	ACERO AL CARBONO				ACERO RÁPIDO			
Medida	Ø 1"	Ø 1 1/2"	Ø 2"	Ø 2 1/2"	Ø 1"	Ø 1 1/2"	Ø 2"	Ø 2 1/2"
Nº 4-40	4.744				8.777			
Nº 5-40	4.744				8.777			
Nº 6-32	4.744				8.777			
Nº 8-32	4.744				8.777			
Nº 10-24	4.744	7.879			8.777	13.806		
Nº 12-24	4.744	7.879			8.777	13.806		
.1/4-20	4.744	7.879	16.036		8.777	13.806	27.611	
5/16-18	4.744	7.879	16.036		8.777	13.806	27.611	
.3/8-16	4.744	7.879	16.036		8.777	13.806	27.611	
.7/16-14	4.744	7.879	16.036		8.777	13.806	27.611	
.1/2-13	4.744	7.879	16.036		8.777	13.806	27.611	
9/16-12		7.879	16.036			13.806	27.611	
.5/8-11		7.879	16.036			13.806	27.611	
11/16-11		7.879	16.036			13.806	27.611	
.3/4-10		7.879	16.036			13.806	27.611	
.7/8-9			16.036				27.611	
1" - 8			16.036	37.996			27.611	67.134
1" 1/8-7			20.848	37.996			27.611	67.134
1" 1/4-7				37.996				67.134
1" 3/8-6				37.996				67.134
1" 1/2-6				37.996				67.134

UNEF

UNEF	ACERO AL CARBONO				ACERO RÁPIDO			
Medida	Ø 1"	Ø 1 1/2"	Ø 2"	Ø 2 1/2"	Ø 1"	Ø 1 1/2"	Ø 2"	Ø 2 1/2"
Nº 12-32	4.744				8.777			
.1/4-32	4.744	7.879	20.848		8.777	13.806	27.611	
5/16-32	4.744	7.879	20.848		8.777	13.806	27.611	
.3/8-32	4.744	7.879	16.036		8.777	13.806	27.611	
.7/16-28	4.744	7.879	16.036		8.777	13.806	27.611	
.1/2-28	4.744	7.879	16.036		8.777	13.806	27.611	
9/16-24		7.879	16.036			13.806	27.611	
.5/8-24		7.879	16.036			13.806	27.611	
11/16-24		7.879	20.848			13.806	27.611	
.3/4-20		7.879	16.036			13.806	27.611	
13/16-20			20.848				27.611	
.7/8-20			16.036				27.611	
15/16-20			20.848				27.611	
1" - 20			16.036	37.996			27.611	67.134
1" 1/8-18			20.848	37.996			27.611	67.134
1" 3/16-18				37.996				67.134
1" 1/4-18				37.996				67.134



1" 5/16-18			37.996			67.134
1" 3/8-18			37.996			67.134
1" 7/16-18			37.996			67.134
1" 1/2-18			37.996			67.134



COJINETES REDONDOS PARA HACER ROSCAS CON TORNILLO DE REGISTRO								
BSPT								
BSPT	ACERO AL CARBONO				ACERO RÁPIDO			
Medida	Ø 1"	Ø 1 1/2"	Ø 2"	Ø 2 1/2"	Ø 1"	Ø 1 1/2"	Ø 2"	Ø 2 1/2"
.1/8-28	6.068	10.248	20.984		10.598	18.410	36.610	
.1/4-19		10.248	20.984			18.410	36.610	
.3/8-19		10.248	20.984			18.410	36.610	
.1/2-14		10.248	20.984			18.410	36.610	
.5/8-14			20.984				36.610	
.3/4-14			20.984	48.808			36.610	86.047
.7/8-14				48.808				86.047
1" -11				48.808				86.047
1" 1/4-11				48.808				86.047
NPS								
NPS	ACERO AL CARBONO				ACERO RÁPIDO			
Medida	Ø 1"	Ø 1 1/2"	Ø 2"	Ø 2 1/2"	Ø 1"	Ø 1 1/2"	Ø 2"	Ø 2 1/2"
.1/8-27	4.744	7.879	16.036		8.777	13.806	27.611	
.1/4-18		7.879	16.036			13.806	27.611	
.3/8-18		7.879	16.036			13.806	27.611	
.1/2-14		7.879	16.036			13.806	27.611	
.5/8-14			16.036				27.611	
.3/4-14			16.036	37.996			27.611	67.134
.7/8-14				37.996				67.134
1" -11 1/2				37.996				67.134
UNF								
UNF	ACERO AL CARBONO				ACERO RÁPIDO			
Medida	Ø 1"	Ø 1 1/2"	Ø 2"	Ø 2 1/2"	Ø 1"	Ø 1 1/2"	Ø 2"	Ø 2 1/2"
Nº 4-48	4.744				8.777			
Nº 5-44	3.840				6.629			
Nº 6-40	3.840				6.629			
Nº 8-36	3.840				6.629			
Nº10-32	3.840	7.879			6.629	13.806		
Nº12-28	3.840	7.879			6.629	13.806		
.1/4-28	3.840	6.068	16.036		6.629	10.598	27.611	
5/16-24	3.840	6.068	16.036		6.629	10.598	27.611	
.3/8-24	3.840	6.068	12.339		6.629	10.598	21.615	
.7/16-20	4.744	6.068	12.339		8.777	10.598	21.615	
.1/2-20	4.744	6.068	12.339		8.777	10.598	21.615	
9/16-18		6.068	12.339			10.598	21.615	
.5/8-18		6.068	12.339			10.598	21.615	
11/16-18 NS		7.879	16.036			13.806	27.611	
.3/4-16		6.068	12.339			10.598	21.615	
13/16-16			16.036				27.611	
.7/8-14			12.339				21.615	
15/16-14			16.036				27.611	
1" -12			12.339	37.996			21.615	67.134
1" 1/8-12			16.036	29.643			27.611	51.663
1" 1/4-12				29.643				51.663
1" 3/8-12				29.643				51.663
1" 1/2-12				37.996				67.134

COJINETES REDONDOS PARA HACER ROSCAS CON TORNILLO DE REGISTRO

UN

Medida	ACERO AL CARBONO				ACERO RÁPIDO			
	Ø 1"	Ø 1 1/2"	Ø 2"	Ø 2 1/2"	Ø 1"	Ø 1 1/2"	Ø 2"	Ø 2 1/2"
5/16-20	4.744	7.879	12.573		8.777	13.806	35.894	
5/16-28	4.744	7.879	12.573		8.777	13.806	35.894	
.3/8-20	4.744	7.879	16.036		8.777	13.806	35.894	
.3/8-28	4.744	7.879	16.036		8.777	13.806	35.894	
7/16-16	6.166	7.879	16.036		11.410	13.806	35.894	
7/16-32	6.166	7.879	16.036		11.410	13.806	35.894	
.1/2-16	6.166	7.879	16.036		11.410	13.806	35.894	
.1/2-32	6.166	7.879	16.036		11.410	13.806	35.894	
9/16-16		7.879	16.036			13.806	35.894	
9/16-20		7.879	16.036			13.806	35.894	
9/16-28		7.879	16.036			13.806	35.894	
9/16-32		7.879	16.036			13.806	35.894	
.5/8-12		7.879	16.036			13.806	35.894	
.5/8-16		7.879	16.036			13.806	35.894	
.5/8-20		7.879	16.036			13.806	35.894	
.5/8-28		7.879	16.036			13.806	35.894	
.5/8-32		7.879	16.036			13.806	35.894	
11/16-12		7.879	16.036			13.806	35.894	
11/16-16		7.879	16.036			13.806	35.894	
11/16-20		7.879	16.036			13.806	35.894	
11/16-28		7.879	16.036			13.806	35.894	
11/16-32		7.879	16.036			13.806	35.894	
.3/4-12		7.879	16.036			13.806	35.894	
.3/4-28		7.879	16.036			13.806	35.894	
.3/4-32		7.879	16.036			13.806	35.894	
13/16-12			12.573				35.894	
13/16-16			12.573				35.894	
13/16-28			12.573				35.894	
13/16-32			12.573				35.894	
.7/8-12			16.036				27.611	
.7/8-16			16.036				27.611	
.7/8-28			16.036				27.611	
.7/8-32			16.036				27.611	
15/16-12			12.573				35.894	
15/16-16			12.573				35.894	
15/16-28			12.573				35.894	
15/16-32			12.573				35.894	
1" - 16			16.036	37.996			27.611	51.663
1" - 18			16.036	37.996			27.611	51.663
1" - 32			16.036	37.996			35.894	51.663
1" 1/16-8			12.573	37.996			35.894	51.663
1" 1/16-12			12.573	37.996			35.894	51.663
1" 1/16-16			12.573	37.996			35.894	51.663
1" 1/16-20			12.573	37.996			35.894	51.663
1" 1/16-28			12.573	37.996			35.894	51.663
1" 1/8-8			12.573	37.996			35.894	51.663
1" 1/8-16			12.573	37.996			35.894	51.663
1" 1/8-20			12.573	37.996			35.894	51.663
1" 1/8-28			12.573	37.996			35.894	51.663
1" 3/16-8			12.573	37.996			35.894	51.663
1" 3/16-12			12.573	37.996			35.894	51.663
1" 3/16-16			12.573	37.996			35.894	51.663
1" 3/16-20			12.573	37.996			35.894	51.663
1" 3/16-28			12.573	37.996			35.894	51.663
1" 1/4-8				37.996				51.663
1" 1/4-16				37.996				51.663



1" 1/4-20				37.996			51.663
1" 1/4-28				37.996			51.663
1" 5/16-8				37.996			51.663
1" 5/16-12				37.996			51.663
1" 5/16-16				37.996			51.663
1" 5/16-20				37.996			51.663
1" 5/16-28				37.996			51.663
1" 3/8-8				37.996			51.663
1" 3/8-16				37.996			51.663
1" 3/8-20				37.996			51.663
1" 3/8-28				37.996			51.663
1" 7/16-6				49.395			67.162
1" 7/16-8				49.395			67.162
1" 7/16-12				49.395			67.162
1" 7/16-16				49.395			67.162
1" 7/16-20				49.395			67.162
1" 7/16-28				49.395			67.162
1" 1/2-8				49.395			67.162
1" 1/2-16				49.395			67.162
1" 1/2-20				49.395			67.162
1" 1/2-28				49.395			67.162



COJINETES REDONDOS PARA HACER ROSCAS CON TORNILLO DE REGISTRO

UNS								
Medida	ACERO AL CARBONO				ACERO RÁPIDO			
	Ø 1"	Ø 1 1/2"	Ø 2"	Ø 2 1/2"	Ø 1"	Ø 1 1/2"	Ø 2"	Ø 2 1/2"
.1/4-24	4.744	7.879			8.777	13.806		
.1/4-27	4.744	7.879			8.777	13.806		
.1/4-36	4.744	7.879			8.777	13.806		
.1/4-40	4.744	7.879			8.777	13.806		
.1/4-48	4.744	7.879			8.777	13.806		
.1/4-56	4.744	7.879			8.777	13.806		
5/16-27	4.744	7.879			8.777	13.806		
5/16-36	4.744	7.879			8.777	13.806		
5/16-40	4.744	7.879			8.777	13.806		
5/16-48	4.744	7.879			8.777	13.806		
.3/8-18	4.744	7.879	16.036		8.777	13.806	27.611	
.3/8-27	4.744	7.879	16.036		8.777	13.806	27.611	
.3/8-36	4.744	7.879	16.036		8.777	13.806	27.611	
.3/8-40	4.744	7.879	16.036		8.777	13.806	27.611	
7/16-18	6.166	7.879	16.036		11.410	13.806	27.611	
7/16-24	6.166	7.879	16.036		11.410	13.806	27.611	
7/16-27	6.166	7.879	16.036		11.410	13.806	27.611	
.1/2-12	6.166	7.879	16.036		11.410	13.806	27.611	
.1/2-14	6.166	7.879	16.036		11.410	13.806	27.611	
.1/2-18	6.166	7.879	16.036		11.410	13.806	27.611	
.1/2-24	6.166	7.879	16.036		11.410	13.806	27.611	
.1/2-27	6.166	7.879	16.036		11.410	13.806	27.611	
9/16-14		7.879	16.036			13.806	27.611	
9/16-27		7.879	16.036			13.806	27.611	
.5/8-14		7.879	16.036			13.806	27.611	
.5/8-27		7.879	16.036			13.806	27.611	
.3/4-14		7.879	16.036			13.806	27.611	
.3/4-18		7.879	16.036			13.806	27.611	
.3/4-24		7.879	16.036			13.806	27.611	
.3/4-27		7.879	16.036			13.806	27.611	
.7/8-10			16.036				27.611	
.7/8-18			16.036				27.611	
.7/8-24			16.036				27.611	
.7/8-27			16.036				27.611	
1" -10			16.036	49.395			27.611	67.162

1" -14			16.036	49.395			27.611	67.162
1" -18			16.036	49.395			27.611	67.162
1" -24			16.036	49.395			27.611	67.162
1" -27			16.036	49.395			27.611	67.162
1" 1/8-10			12.573	37.996			35.894	51.663
1" 1/8-14			12.573	37.996			35.894	51.663
1" 1/8-24			12.573	37.996			35.894	51.663
1" 1/4-10				37.996				51.663
1" 1/4-14				37.996				51.663
1" 1/4-24				37.996				51.663
1" 3/8-10				37.996				51.663
1" 3/8-14				37.996				51.663
1" 3/8-24				37.996				51.663
1" 1/2-10				49.395				67.162
1" 1/2-14				49.395				67.162
1" 1/2-24				49.395				67.162

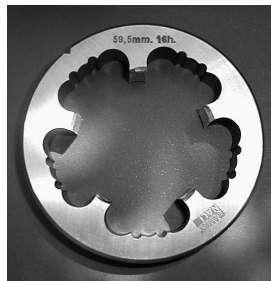

COJINETES ESPECIALES HASTA DIÁMETRO EXTERIOR 6"									
Ø EXTERIOR		Ø DE LA ROSCA mm.	Espesor	PRECIO			PRECIO		
Ø"	mm			carbono	RAPIDO	Espesor	carbono	RAPIDO	
3"	76,20	Desde 34 hasta 43 mm.	18 mm	54.485	77.836	25 mm	72.130	103.041	
3 1/2"	88,90	Desde 38 hasta 50 mm.	18 mm	85.942	122.775	25 mm	112.797	161.139	
4"	101,60	Desde 40 hasta 57 mm.	20 mm	125.688	179.555	30 mm	163.442	233.488	
4 1/2"	114,30	Desde 43 hasta 64 mm.	20 mm	182.932	261.332	36 mm	237.719	339.600	
5"	127,00	Desde 48 hasta 71 mm.	22 mm	251.532	359.332	36 mm	326.881	466.974	
5 1/2"	139,70	Desde 52 hasta 78 mm.	22 mm	320.742	458.203	38 mm	416.503	595.005	
6"	152,40	Desde 57 hasta 85 mm.	22 mm	400.238	571.768	38 mm	520.251	743.215	

OBSERVACIONES:

Los diámetros que se encuentren por encima y/o por debajo de los indicados en la columna "diámetro exterior", así como las medidas con rosca IZQUIERDA sufrirán un recargo del 25 %.

Las medidas cónicas 1:16 sufrirán un recargo del 35 %.

Las demás piezas de fabricación especial, serán cotizadas de acuerdo al diseño requerido por el cliente.

Cojinetes norma DIN 223 (EN 22586)

EXTERIOR D	ESPESOR H	SUJECIÓN	
		LATERAL	FRONTAL
16 mm	5 mm	19.392	25.210
20 mm	5 mm	13.332	17.332
20 mm	7 mm	14.060	18.278
25 mm	9 mm	14.544	18.907
30 mm	11 mm	19.392	25.210
38 mm	10 mm	21.332	27.731
38 mm	14 mm	21.816	28.361
45 mm	14 mm	33.936	44.117
45 mm	18 mm	38.784	50.419
55 mm	15 mm	61.570	80.041
55 mm	22 mm	68.842	89.494
65 mm	18 mm	84.840	110.292
65 mm	25 mm	92.112	119.745

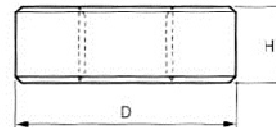

Los valores mencionados en esta lista de precios, pueden sufrir variaciones por diferencias de redondeo con el sistema de facturación.

RAVAT NALI S.R.L.

Triunvirato 2752 – (B1753GQV)
V. Luzuriaga – Pcia. De Buenos Aires
República Argentina
Tel.: 54 (11) 4659-2695



+541152486181

www.ravatnali.com

cojinetes@ravatnali.com